

~ Las Palmas ~

Contents / Inhalt / Contenu / Inhoud:

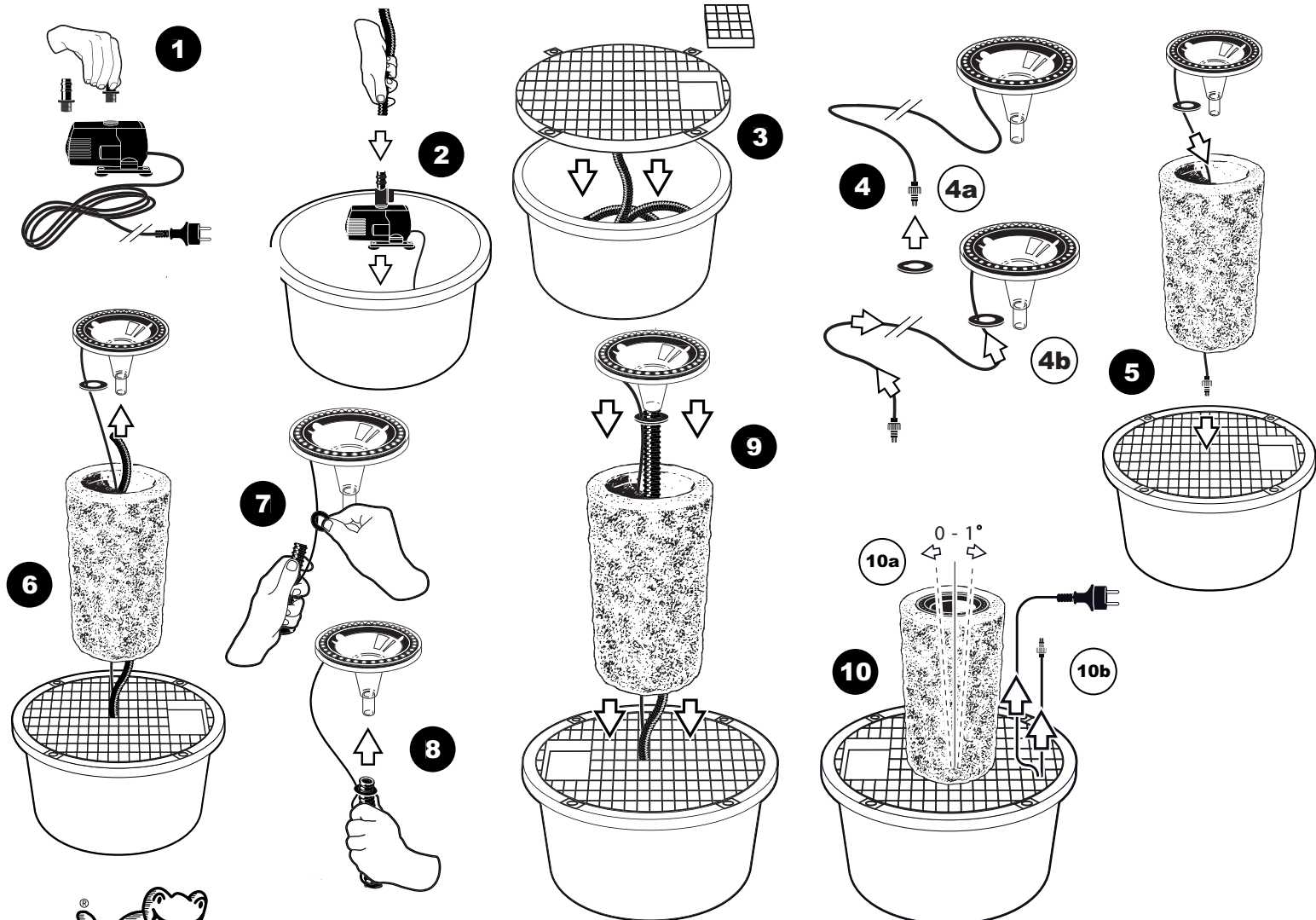

~ Las Palmas ~

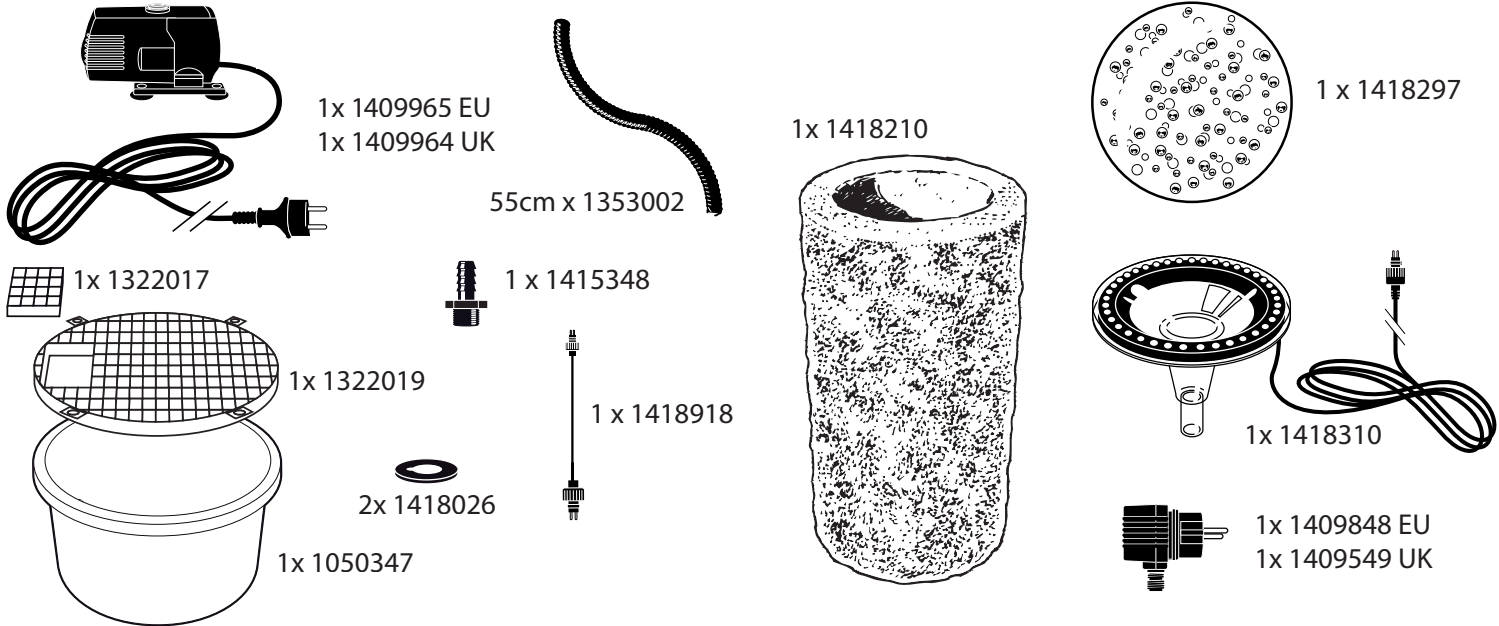
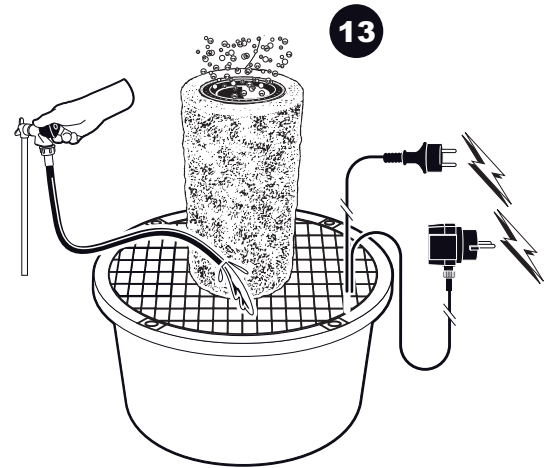
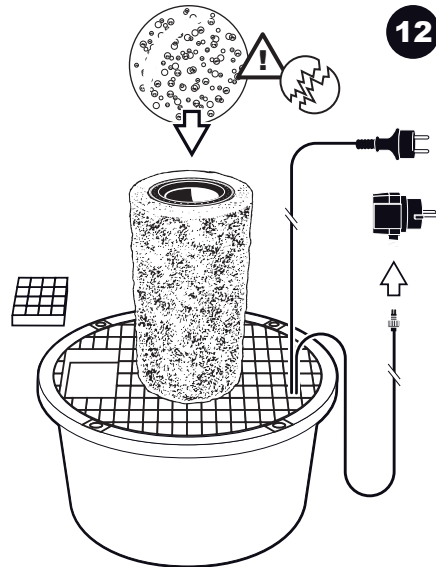
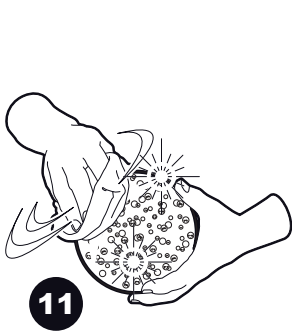

- NL** Geen chloor toevoegen in het water.
- D** Dem Wasser **KEIN** Chlor zufügen.
- GB** Do not place chlorine into the water.
- F** Ne pas ajouter de chlore dans l'eau.

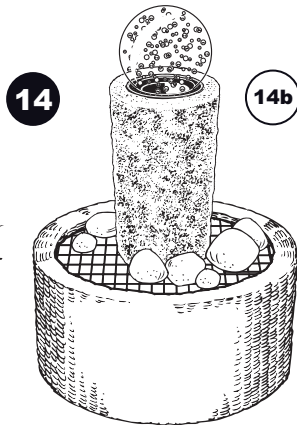
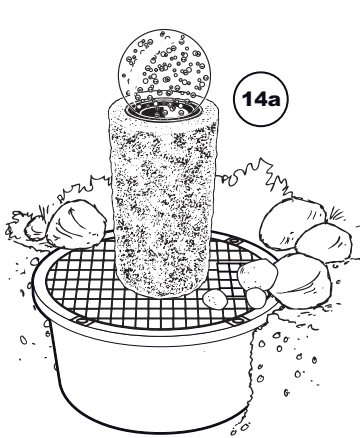

- During severe frost switch off the pump, remove ornament and pump!
- Bei strengem Frost sollte das Set ausgeschaltet sowie das Deko-Element und Pumpe entfernt werden!
- Tijdens strenge vorst set uitschakelen, ornament en pomp verwijderen!
- Protégez votre fontaine décorative et mettez votre pompe à l'arrêt pendant la période d'hiver.